

A

B

C

D

E

REVISION HISTORY					
REV	BY	RELEASE DATE	DESCRIPTION	ORIGINATOR	CHANGE ORDER
A	EM	10/25/22	FIRST RELEASE	EM	5696

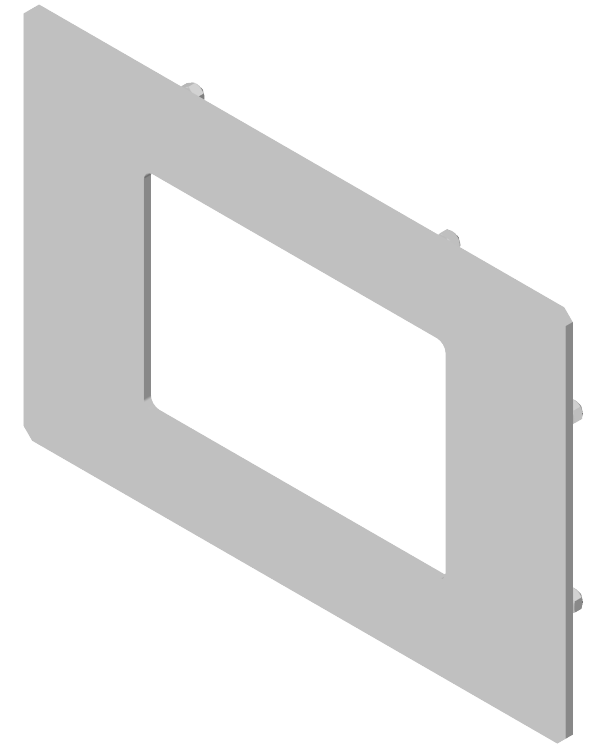
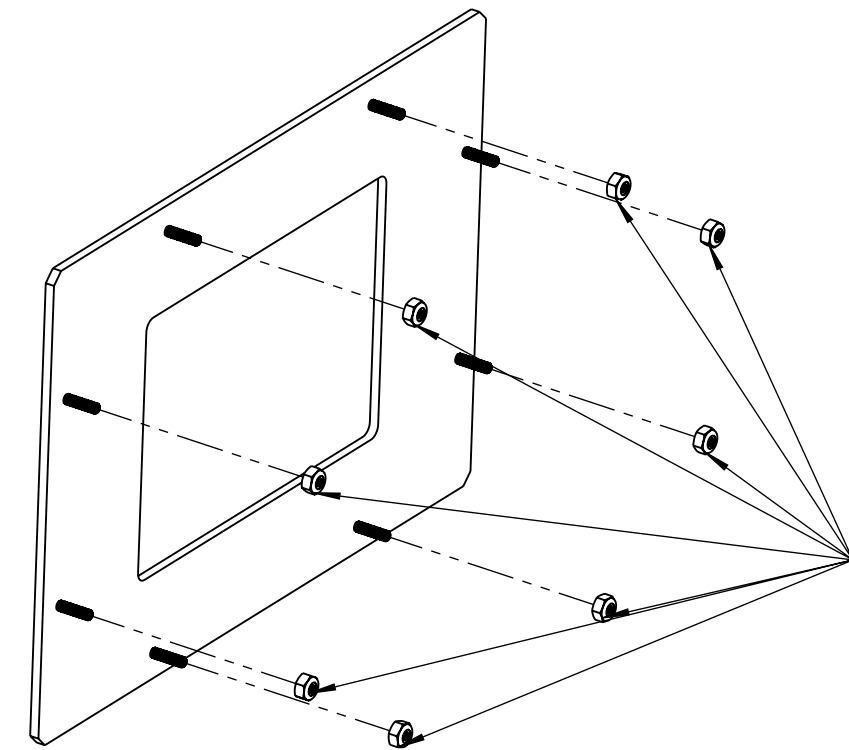
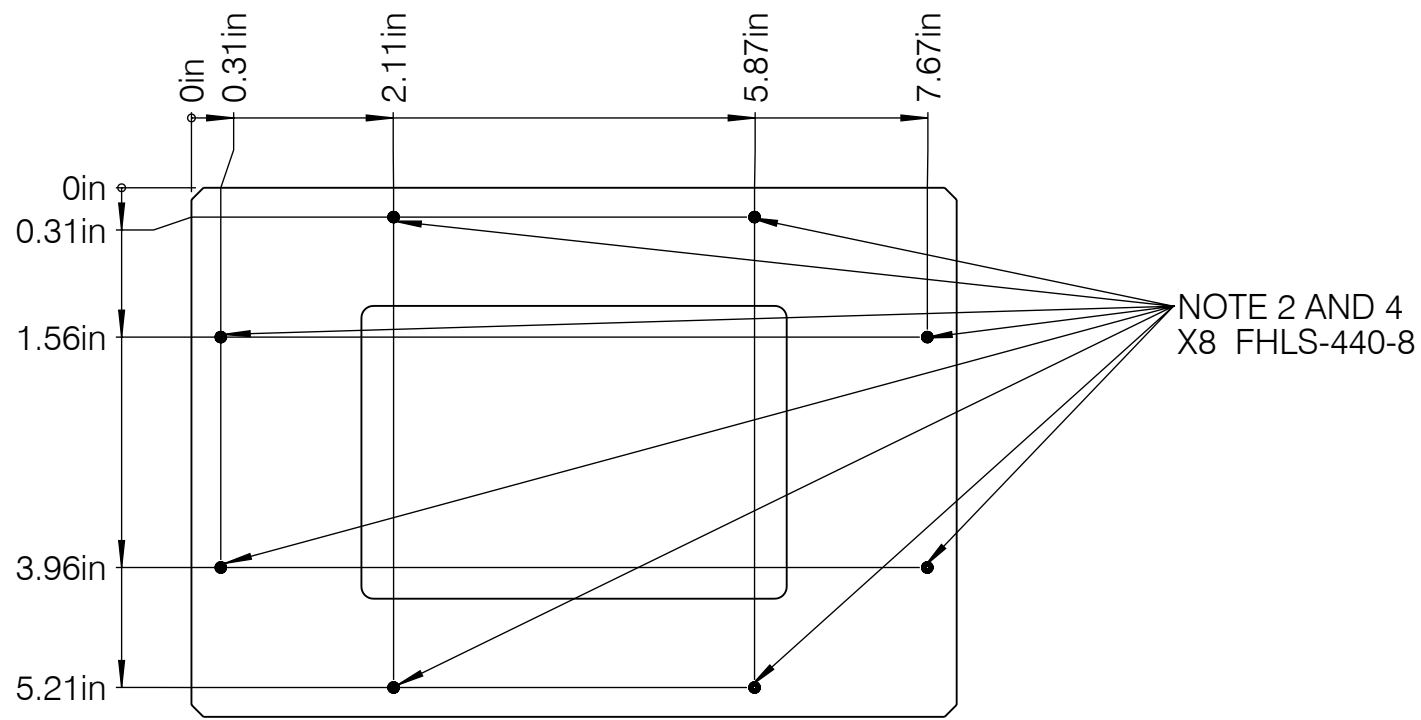
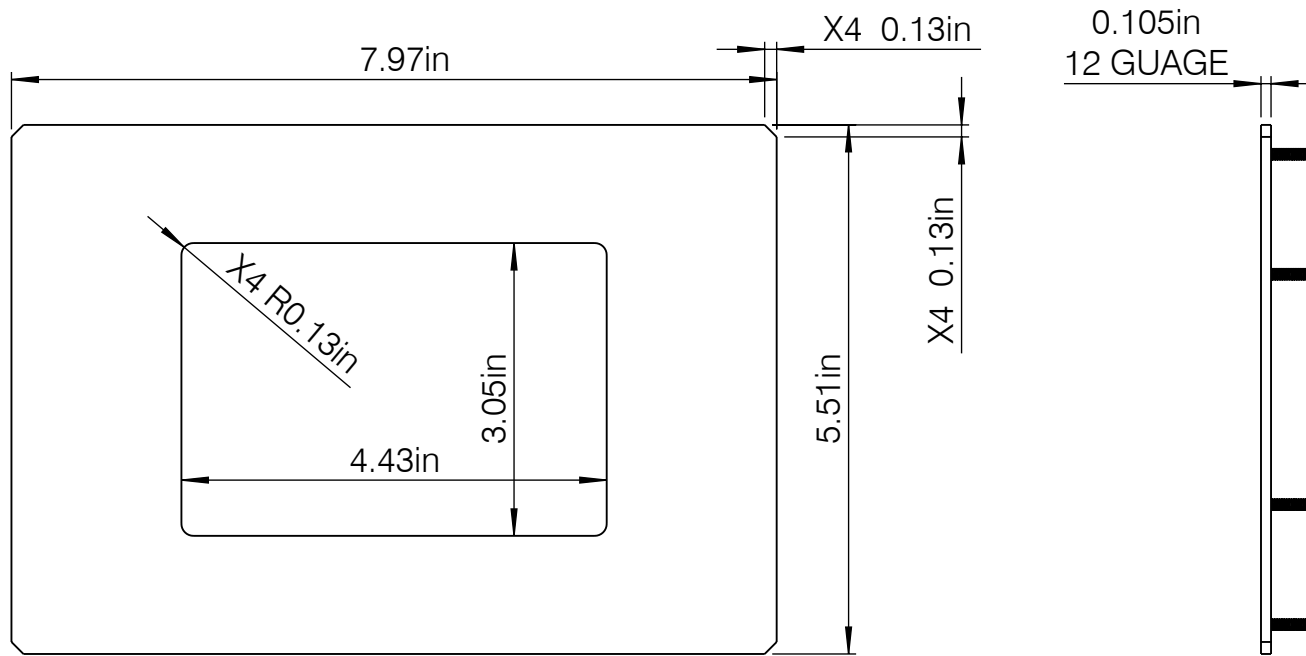

NOTE 5  
PART # U12423.011.0001  
QTY OF 8 NUTS

- NOTE:
1. DEBUR ALL EDGES
  2. PRESS IN STUDS (PART # FHLS-440-8)
  3. FINISH -ANSI 61 GREY POLYESTER POWDERCOAT ALL SIDES
  4. MASK PRESS IN THREADED STUDS
  5. INSTALL NUTS UNTILL THE LOCK NUTS SELF HOLD (PART # U12423.011.0001)

**SOLIDWORKS GENERATED DRAWING**

THESE DRAWINGS AND SPECIFICATIONS ARE THE PROPERTY OF ELECTRO INDUSTRIES AND SHALL NOT BE REPRODUCED, COPIED, OR USED FOR MANUFACTURE OR SALE OF APPARATUS WITHOUT WRITTEN PERMISSION OF ELECTRO INDUSTRIES.

TOLERANCES AND SYMBOLGY PER ANSI/AMSE Y14.5M-1994 DIMENSIONS SPECIFIED ARE AFTER ADDITIVE FINISH.

DECIMALS .XX ± 0.010 .XXX ± 0.005 for 1st 5 inches plus 0.001 each additional inch.)	ANGLES XX ± 0.5° XX.X ± 0.1°	<b>MATERIAL:</b> COLD ROLLED STEEL
SURF. FINISH SEE NOTES	DRAWN BY: EM DATE: 10/25/22	<b>TITLE:</b> P70N ADAPTER PLATE  <b>TITLE DESCRIPTION:</b> <b>P60N TO P70N MOUNTING PLATE</b>
FOR DIMENSIONS NOT SHOWN USE DIGITAL DATA. FILE NAME: E171316-A-10-25-22.ZIP	ENGINEERING CHECK: TB DATE: 10/25/22	
	DOCUMENTATION CHECK: TF DATE: 10/25/22	

**TITLE:** P70N ADAPTER PLATE

**TITLE DESCRIPTION:**  
**P60N TO P70N MOUNTING PLATE**

SIZE	SCALE
B	DO NOT SCALE DRAWING

PART NUMBER: E171316

REV. NO	CHANGE ORDER	RELEASE DATE	SHEET
A	5696	10/25/22	1 OF 1

A

B

C

D

E